



Key Features

- 19" Intel Core i7/i5 Fanless Industrial Panel PC
- Intel 3rd gen. IVY-bridge Core i7/i5 CPU
- 19" LCD 4:3 1280x1024 350nits
- Resistive touch with front IP66 design
- Front Panel mount housing
- CE, FCC, VCCI Class A passed
- Optional Mini-PCIe WLAN with external antenna



Outline Drawing

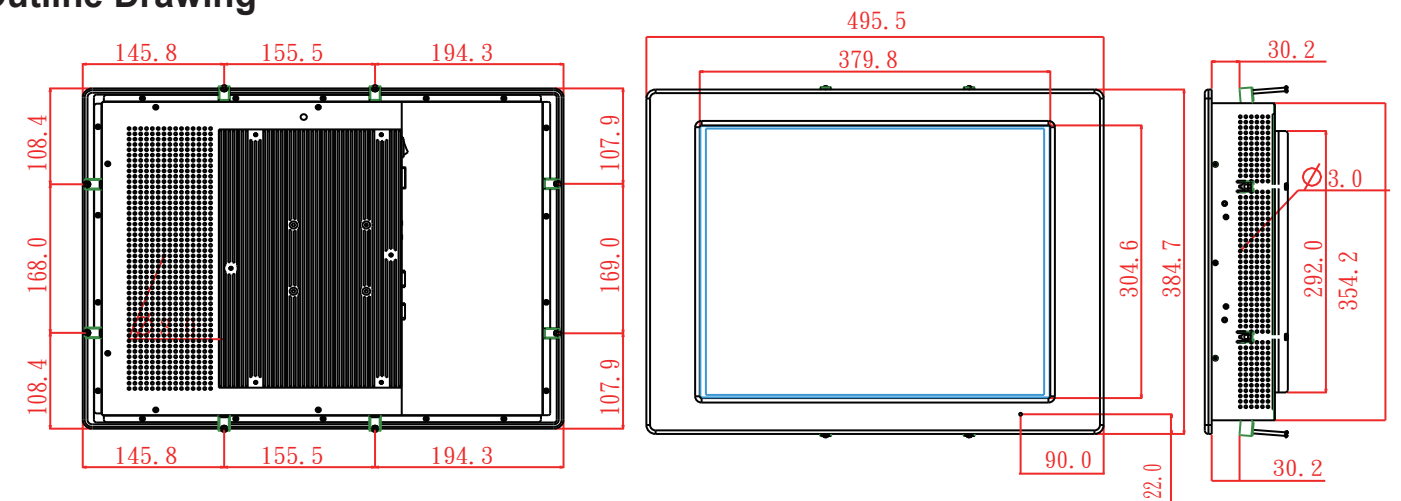

Main System

CPU	FCBGA1023 3rd Generation Intel Core i7/i5/i3/Celeron processor (17W max.)
Chipset	Intel HM65
Graphics	Intel® integrated HD Graphics 4000
Memory	Two 1600 MHz DDR3 SODIMM socket support dual Channel, non-ECC, up to 16 GB

LCD Panel

Size	19" 4:3
Brightness	350 nits
Resolution	SXGA (1280 x 1024)
Color numbers	16.7 M (6-bit x 3 + FRC)
Viewing angle	170 (H) / 160 (V)
Contrast	1000:1

Touch Panel

Technology	5-wire resistive touch (default)	Projected capacitive touch (option)
Type	Front full flat touch panel	Front full flat 2 point touch panel
Transparency	80±5%	90% ± 3%
Hardness	4H	7H
Durability	Knock 35 million times	Knock 100 million times

* OS support (Multi point) : Win 7 pro, Win 8, Win 8.1 industrial, Win10

Storage & Expansion

HDD	2.5" SATA HDD drive bay x 1 + anti-vibration kit, 320 / 500 GB
Expansion slot	Mini PCIe x 2 (52 pin card-edge type)

Ordering Information

WLP-7A20-19V BKRT (i5)	R-Touch	Core i5-3317U / 2G RAM / 320G HDD
WLP-7A20-19V BKPT (i5)	P-cap Touch	Core i5-3317U / 2G RAM / 320G HDD

I/O & Power & Control Keys

USB	USB 2.0 x 4
COM	DB-9 x 3 {RS232 x 2, RS232/422/485 x 1 (Set by BIOS, RS485 auto flow)}
LAN	RJ-45 x 2, Gigabit
Audio	Line-out, Microphone-in (3.5 mm phone-jack)
DVI output	DVI-I x 1
Power input	DC-in x 1, 12V~28V
Power adaptor	AC 90 ~ 264V / 47 ~ 63 Hz / DC output 12V, 57W
Power consumption	46.495 watts (MAX. Loading without adaptor)
Control keys	Rear bottom: Power on/off, reset

Mechanical & Environmental

Housing	Front bezel is Aluminum, others are SECC
IP rating	Front IP66
Cooling	Fanless
Dimension	495.5 x 384.7 x 90 mm (W x H x D, panel mount)
Weight (net)	9 Kg (approximate, w/o power adaptor)
Temperature	• Operating: 0°C~50°C (w/ air flow) / 0°C~40°C (no air flow) • Storage: -20°C~60°C
Humidity	Operating & storage – 10%~90%, non-condensing
Regulatory	FCC-A, CE (EMC), VCCI, UL

Options

- Wireless or Wireless + BT kit (2 ant)
- Silver front bezel
- Stainless front bezel
- Change resistive touch to capacitive touch (BKRT)
- Change resistive touch to P-cap touch (BKPT)

Customization

- Open frame housing
- Chassis type housing
- TPM module



WLP-7A20-19V BKPT

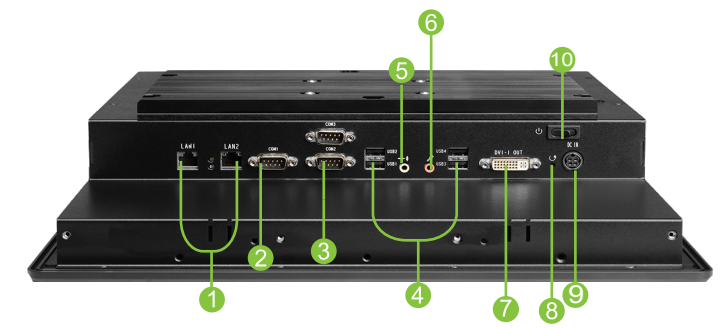

- ① LAN x 2
- ② RS232/422/485
- ③ RS232 x 2
- ④ USB x 4
- ⑤ Line out
- ⑥ Microphone-in
- ⑦ DVI-I
- ⑧ Reset
- ⑨ DC-in
- ⑩ Power on/off



Stainless front bezel (Option)