

B26

3MP Zoom Box with D/N, Extreme WDR, SLLS, 36x Zoom Lens



- 3 Megapixel
- Day & Night with Superior Low Light Sensitivity
- 36x Zoom Lens with f4.6-165.6mm/F1.55-F5.0, DC iris, Auto focus
- Extreme WDR
- H.265 Compression
- Event trigger, response and notification

► Specifications

Device

| | |
|----------------------------------|--|
| Product Type | Zoom Box |
| Maximum Resolution | 3MP |
| Application Environment | Indoor/Outdoor |
| Image Sensor | Progressive Scan CMOS |
| Sensor Size | 1/2.8 " |
| Effective Pixels | 2065(H) X 1553(V) (3.21 MP) |
| Day / Night | Yes |
| Low Light Sensitivity | Superior |
| Minimum Illumination | Color: 0.003 lux at F1.55; B/W: 0.002 lux at F1.55 |
| Color to B/W Switch | ISP based switch, configurable |
| Mechanical IR Cut Filter | Yes |
| IR Sensitivity Range | 700-1100nm |
| IR LED | No |
| Electronic Shutter | 1/5-1/64000 second (manual mode); 1/5-1/64000 second (auto mode) |
| Horizontal Resolution (TV Lines) | 1450 TVL |

| | |
|-----------|-------|
| S/N Ratio | 56 dB |
|-----------|-------|

Lens

| | |
|--------------------------|---|
| Focal Length | Zoom, f4.6-165.6mm |
| Aperture | F1.55-F5.0 |
| Zoom Ratio | 36x optical zoom |
| Zoom Application | Camera Installation, Auto Zoom by Event, Manual Operation |
| Iris | DC iris |
| Focus | Auto focus |
| Lens Mount | Board mount |
| Horizontal Viewing Angle | 57.6° - 2.35° |
| Vertical Viewing Angle | 44.9° - 1.78° |

PTZ

| | |
|----------------------------|---|
| Absolute Position | Yes |
| Pan, Tilt or Zoom protocol | Visca, Pelco-D, Pelco-P, ACTi URL command |

Video

| | |
|-----------------------------------|---|
| Compression | H.265, H.264 (Baseline/ Main/ High profile), MJPEG |
| Maximum Frame Rate vs. Resolution | 30 fps at 2048 x 1536 30 fps at 1920 x 1080 30 fps at 1280 x 960 30 fps at 1280 x 720 30 fps at 800 x 600 30 fps at 640 x 480 30 fps at 320 x 240 |
| Multi-Streaming | Simultaneous triple streams based on three configurations |
| Bit Rate | 128Kbps - 12Mbps (per stream) |
| Bit Rate Mode | Constant, Variable |
| Wide Dynamic Range | Extreme WDR (145 dB) |
| Image Enhancement | White Balance, Brightness, Contrast, Saturation, Sharpness, Automatic gain control, Flickerless, Defogging |
| Digital Noise Reduction | 2D + 3D DNR |
| Privacy Mask | 32 configurable 3D privacy masks (To be available through future firmware upgrade) |
| Text Overlay | Yes |
| Built-in Analytics | Object Based Motion Detection, Tampering Detection, Shock Detection |
| Server-based Analytics | Object Line Counting, People Counting, Face Detection, Object Based Motion Detection, Tamper, Object Line Crossing Detection, Object Enter Area Detection, Missing Object Detection, Unattended Object Detection, Smoke Detection, Heat Map, Dwell Time, People Queue Detection, (Require PC-based or standalone IVS or ALPR Server. Contact ACTi support for recommendations on how to maximize analytical accuracy) |
| Image Orientation | Flip, Mirror, Rotation (Corridor mode) |

Audio

| | |
|-------------------|--|
| Audio Type | 2-way, Line-in, Line-out |
| Audio Compression | 8 kHz, 16 bit encoding, Mono, PCM, G.711 |

Network

| | |
|----------------------------|---|
| Network Protocol & Service | IPv4/v6, TCP, UDP, DHCP, PPPoE, HTTP, HTTPS, DNS, DDNS, NTP, RTP, RTSP, RTCP, SMTP, FTP, IGMP, ICMP, ARP, Bonjour, UPnP, QoS, SNMP, IEEE 802.1X |
| Ethernet Port | 1 x RJ-45 connector |
| Security | IP address filtering, HTTPS encryption, Password protected user level, Anonymous login, IEEE 802.1X network access control |

Event

| | |
|----------------|--|
| Event Trigger | Video motion detection (10 included and excluded polygons regions), External device through digital input, Tampering detection, Shock Detection, Sound detection, Video streams loss, System log buffer overrun, Remove system log, Logon events (Login Failure, Login Success, Block an Account) |
| Event Response | Notify control center, Go to Zoom preset point or preset tour, Change camera settings, Command other devices, E-mail notification with snapshots, Push notification to mobile device, Save video to local storage, Upload video to NVR server, Upload video or snapshot to FTP server, Activate external device through digital output |

System

| | |
|------------|---------|
| System Log | Support |
| Watchdog | Support |

Integration

| | |
|-----------------------|---|
| Unified Solution | Fully compatible with ACTi software |
| GPS Position | Manual setting |
| Edge Recording | Support (integration with NVR by ONVIF Profile G or proprietary protocol)** |
| ONVIF Compliant | Yes, Profile S, Profile G, Profile T |
| GB28181 Compliant | Yes |
| Web Browser | IE 11, Google Chrome*, Microsoft Edge*, Apple Safari* |
| Auto Firmware Upgrade | Yes |

Interface

| | |
|----------------------|--|
| Serial Port | 1 x RS-485/RS-422 |
| Local Storage | MicroSDHC, MicroSDXC Memory Card Slot (card not included, up to 256GB, Kingston or Sandisk only) |
| Digital Input/Output | 1/1 |
| Operating Button | Reset Button |

General

| | |
|----------------------|---|
| Power Source | DC 12V, PoE Class 3 (IEEE802.3af) |
| Power Consumption | 10.4 W (PoE), 8.65 W (DC) |
| Weight | 811g (1.788lb) |
| Dimensions | (W x H x D): 80.6mm x 71.4mm x 178.14mm (3.17" x 2.81" x 7.01") |
| Environmental Casing | Optional housing (IP66-IP68) |
| Heater | Yes |

| | |
|-----------------------|--|
| Starting Temperature | -10°C ~ 50°C (14°F ~ 122°F) within 30 minutes |
| Operating Temperature | -20°C ~ 50°C (-4°F ~ 122°F) |
| Operating Humidity | 10% - 85% RH |
| Approvals | CE Class B, FCC Class B, UL (for optional PoE injector and power adapter) |
| Real-time Clock (RTC) | Yes |
| Warranty | 3 Year(s). For extended warranty offering, see http://www.acti.com/support/warranty |

* cross-browser compatibility: Not available for H.265 video decoding and Intelligent Video settings ** Edge Recording function is integrated with NVR 3 Corporate / NVR 3 Business / INR / GNR series.

► Photo Indication

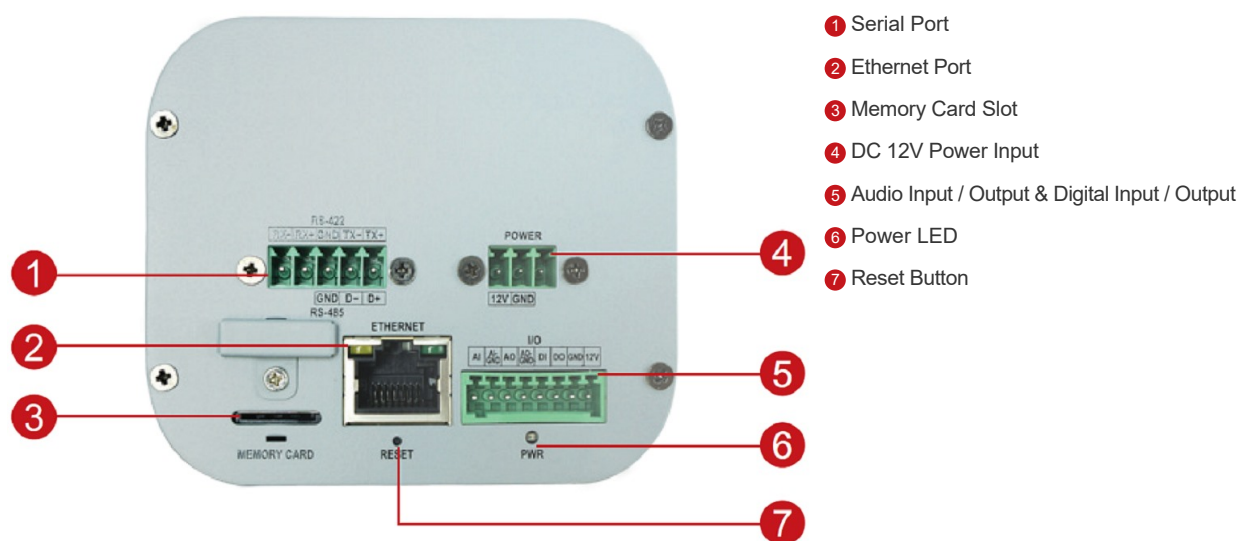



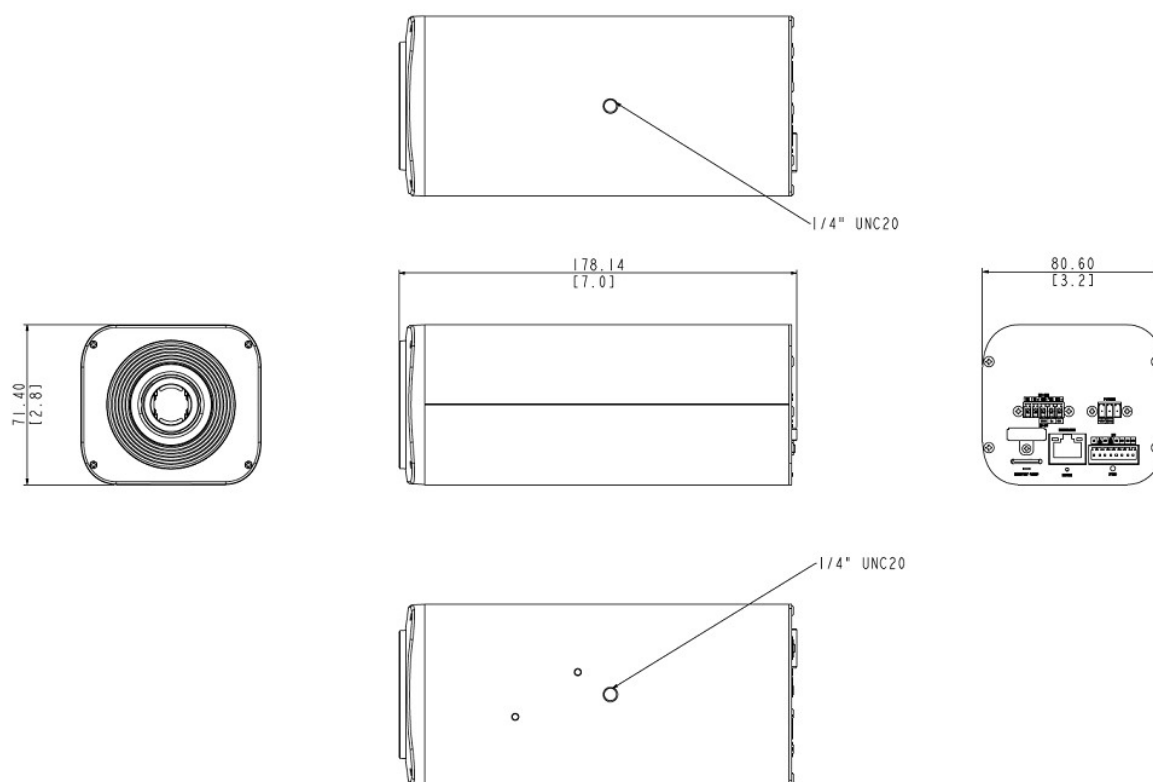



► Dimension Diagram



Unit: mm [inch]

► Related Products

Mounting Accessories - Camera Mount

| | | |
|-----------|---|--|
| PMAX-0402 |  | Corner Mount |
| PMAX-0503 |  | Pole Mount (for PMAX-0102, PMAX-0312, PMAX-0313, PMAX-0314, PMAX-0702, PMAX-1106, PMAX-1107), supports 5.25" to 8.5" Poles |
| PMAX-0508 |  | Pole Mount (for PMAX-0203, PMAX-0204, PMAX-0205, PMAX-0206, PMAX-0704), supports 3" to 9" Poles |
| PMAX-0704 |  | Junction Box (for A4x, B4x, B41x, E44, E45, E46, E48, E44A, E45A, E46A, E41x, I4x, PMAX-0203~PMAX-0205) |
| PMAX-1105 |  | Bracket for Indoor Box Cameras (for B2x) |
| PMAX-1106 |  | Bracket for Outdoor Box Cameras (KCM-5211E, KCM-5511, KCM-5611, Box Cameras with Outdoor Housing) |

Note: Some mounting accessories may need additional accessories for installation. Please check www.acti.com/mountingselector for more information.

Enclosures - Box Camera Housing

| | | |
|-----------|---|---|
| PMAX-0200 |  | Outdoor Housing with Heater and Fan (110V) |
| PMAX-0201 |  | Outdoor Housing with Heater and Fan (220V) |
| PMAX-0202 |  | Outdoor Housing |
| PMAX-0203 |  | Heavy Duty Outdoor Housing with Heater and Fan (230V) and Bracket |
| PMAX-0204 |  | Heavy Duty Outdoor Housing with Heater and Fan (110V) and Bracket |
| PMAX-0205 |  | Heavy Duty Outdoor Housing with Bracket |
| PMAX-0206 |  | PoE Heavy Duty Outdoor Housing with Heater, Fan, Defogger and Bracket |
| PMAX-0208 |  | Explosion Proof Housing with Heater, Fan (AC 110V~220V) and Bracket |
| PMAX-0210 |  | Stainless Steel Housing with Heater, Fan (AC 110V~220V) and Bracket |

Power Supply Accessories - Power Adapter

| | | |
|-----------|---|--|
| PPBX-0011 |  | Power Adapter AC 100~240V, with universal connectors for all DC12V powered devices |
|-----------|---|--|

Power Supply Accessories - PoE Injector

PPOE-0002



PoE Injector IEEE 802.3af compliant, AC 100~240V, with universal connectors

Network & Storage Peripherals - Data Switch

PPSW-0100



PLANET FGSD-910HP 8-Port 802.3at PoE Switch (PoE Budget 120W)

PPSW-0102



PLANET FGSD-1011HP 8-Port 802.3at PoE Switch (PoE Budget 120W)

PPSW-0105



PLANET GS-4210-8P2C 8-Port Gigabit 802.3at Managed PoE Switch (PoE Budget 120W)

PPSW-1101



PLANET GS-4210-24PL4C 24-Port Gigabit 802.3at Managed PoE Switch (PoE Budget 440W)

PPSW-2101



4-Port 802.3at PoE Switch (PoE Budget 62W)

PPSW-3100



PLANET FGSW-1816HPS 16-Port 802.3at PoE Switch (PoE Budget 220W)

Extenders - PoE Extender

PPEX-0100



Veracity OUTREACH Max Power over Ethernet (PoE) Extender

Extenders - PoE over Coaxial Extender Kit

PPOC-0100



Planet LRP-101C-KIT Power over Coax Adapter Kit

Audio Devices - Microphone

PMIC-0100



Active Microphone Omnidirectional for all Cameras with Line-in Audio

Other Accessories - Accessory Part

R707-10000



Mounting Block (for D2x, E2x, B2x, I2x)

Product Demo - Camera Demo Kit

PCDK-0001



Camera Demo Kit Rack Box (350 x 550 x 140 mm) for all cameras except Mini Domes