



DCT-25

ARC to Analog Audio Converter



Operation Manual

HDMI[®]
HIGH-DEFINITION MULTIMEDIA INTERFACE

The terms HDMI, HDMI High-Definition Multimedia Interface, and the HDMI Logo are trademarks or registered trademarks of HDMI Licensing Administrator, Inc.

DISCLAIMERS

The information in this manual has been carefully checked and is believed to be accurate. Cypress Technology assumes no responsibility for any infringements of patents or other rights of third parties which may result from its use.

Cypress Technology assumes no responsibility for any inaccuracies that may be contained in this document. Cypress also makes no commitment to update or to keep current the information contained in this document.

Cypress Technology reserves the right to make improvements to this document and/or product at any time and without notice.

COPYRIGHT NOTICE

No part of this document may be reproduced, transmitted, transcribed, stored in a retrieval system, or any of its part translated into any language or computer file, in any form or by any means—electronic, mechanical, magnetic, optical, chemical, manual, or otherwise—without express written permission and consent from Cypress Technology.

© Copyright 2012 by Cypress Technology.

All Rights Reserved.

Version 1.0 September 2011

TRADEMARK ACKNOWLEDGMENTS

All products or service names mentioned in this document may be trademarks of the companies with which they are associated.



SAFETY PRECAUTIONS

Please read all instructions before attempting to unpack, install or operate this equipment and before connecting the power supply.

Please keep the following in mind as you unpack and install this equipment:

- Always follow basic safety precautions to reduce the risk of fire, electrical shock and injury to persons.
- To prevent fire or shock hazard, do not expose the unit to rain, moisture or install this product near water.
- Never spill liquid of any kind on or into this product.
- Never push an object of any kind into this product through any openings or empty slots in the unit, as you may damage parts inside the unit.
- Do not attach the power supply cabling to building surfaces.
- Use only the supplied power supply unit (PSU). Do not use the PSU if it is damaged.
- Do not allow anything to rest on the power cabling or allow any weight to be placed upon it or any person walk on it.
- To protect the unit from overheating, do not block any vents or openings in the unit housing that provide ventilation and allow for sufficient space for air to circulate around the unit.

REVISION HISTORY

REV.	DATE	SUMMARY OF CHANGE
VR0	07/01/14	Preliminary Release



CONTENTS

1. Introduction	1
2. Applications	1
3. Package Contents	1
4. System Requirements	1
5. Features	1
6. Operation Controls and Functions	2
6.1 Front Panel.....	2
6.2 Rear Panel.....	2
7. Connection Diagram	3
8. Specifications	4
8.1 Audio Specification	4





1. INTRODUCTION

The ARC to Analog Audio Converter is designed to extract audio signal from an HDTV's HDMI ARC (Audio Return Channel) connection and convert it to an analog stereo signal, allowing the connection of an HDTV with HDMI-only output to non-HDMI equipped amplifiers, AV receivers or Active Speakers. It supports HDMI audio sampling rates up to 192kHz and analog stereo 2CH audio output.

2. APPLICATIONS

- Analog audio sound system over digital audio signal
- TV audio output over Active Speakers
- Video Game player

3. PACKAGE CONTENTS

- 1 x ARC to Analog Audio Converter Box
- 1 x 5V DC Power Adaptor
- Operational Manual

4. SYSTEM REQUIREMENTS

Input TV from ARC connection with audio signal and output to AV receivers or Active Speakers.

5. FEATURES

- Supports Digital to Analog audio Conversion (DAC)
- Extracts the HDMI audio signal from an HDTV's ARC connection
- and convert it to an Line-level analog stereo output
- Supports HDMI sampling rate up to 192kHz
- Synchronous output sound on TV and Line out
- Supports volume control from TV's remote control via CEC function
- Plug and play with no software require

Note: *To ensure the ARC audio performance, an HDMI standard ARC cable is required.*

6. OPERATION CONTROLS AND FUNCTIONS

6.1 Front Panel

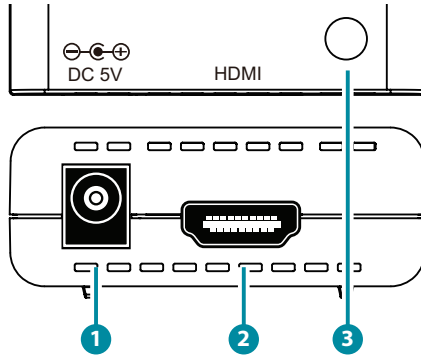

- 1 DC 5V:** Plug the 5V DC power supply into the unit and connect the adaptor to an AC outlet..
- 2 HDMI:** Connect from TV's ARC connector with Audio signal activated.
- 3 POWER LED:** This LED will illuminate when the device is connected with power supply.

6.2 Rear Panel

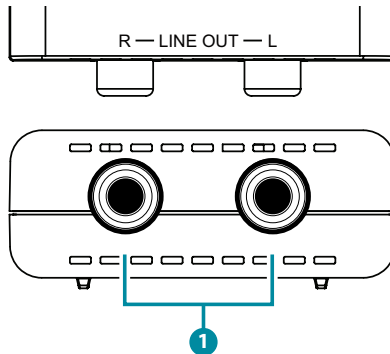

- 1 LINE OUT:**
Connect the R/L OUT to AV receivers or Active Speakers.

7. CONNECTION DIAGRAM

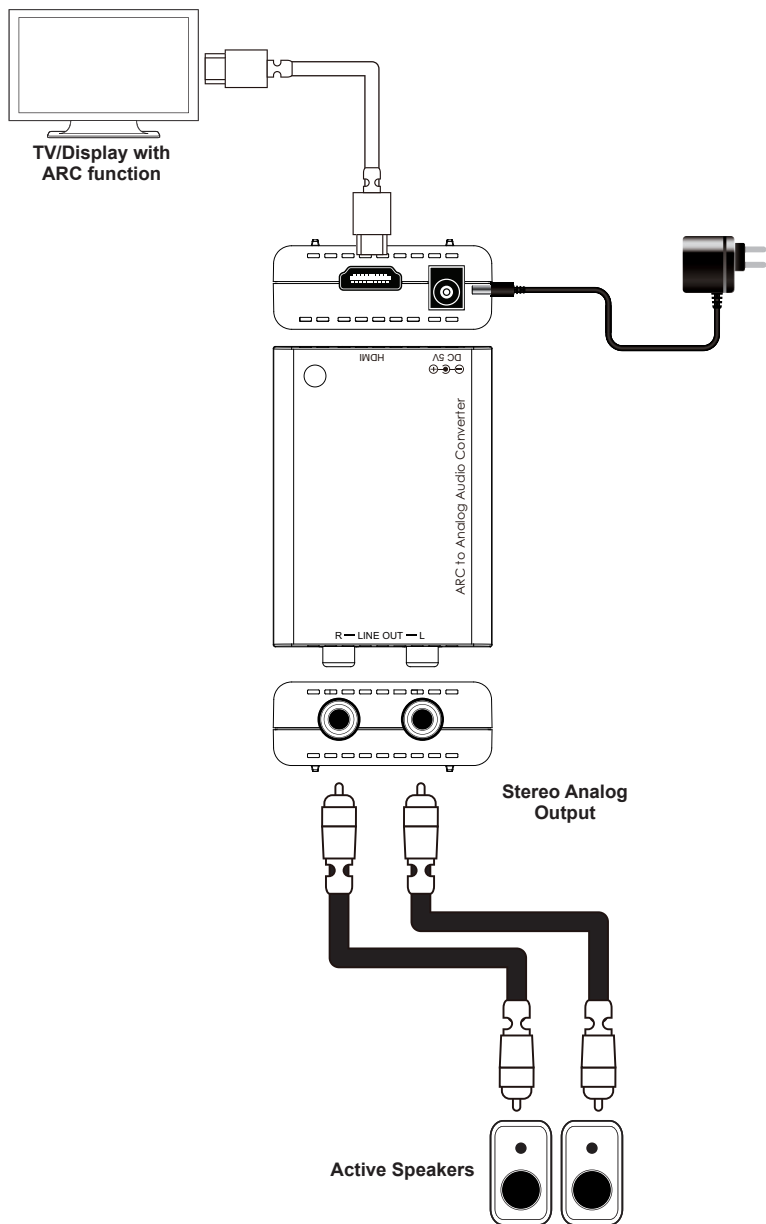

8. SPECIFICATIONS

HDMI ARC port	1 x HDMI
Output Port	1 x Analog Stereo (2RCA)
HDMI Sampling Rate	Up to 192kHz
ESD Protection	Human body model: ±8kV (air-gap discharge) ±4kV (contact discharge)
Power Supply	5V/1A DC (US/EU standards, CE/FCC/UL certified)
Dimensions (mm)	55(W) x 75.5(D) x 22.5(H)/Jacks Excluded 55(W) x 80.5(D) x 22.5(H)/Jacks Included
Weight(g)	46
Chassis Material	Plastic
Silkscreen Color	White
Operating Temperature	0°C ~ 40°C / 32 °F ~ 104 °F
Storage Temperature	-20°C ~ 60°C / -4 °F ~ 140 °F
Relative Humidity	20 ~ 90% RH (non-condensing)
Power Consumption	0.72W

8.1 Audio Specification

Input Level/Freq.	Output	Output Level	T H D +N	Frequency Response	SNR	Crosstalk
HDMI 0dB/ 1kHz 32KHz~192KHz	L/R	2Vrms ±10%	<0.01%	±1 dBFS	>80dB	<-80dB



CYPRESS TECHNOLOGY CO., LTD.
www.cypress.com.tw
