

LockIt Plus • Installation Guide

Follow these instructions to secure the HDMI and USB-C connectors to the unit with the LockIt Plus lacing brackets provided:

1. **Plug in the Cable** – Connect the HDMI or USB-C cable to the port.
2. **Loosen the Screw** – Slightly loosen the mounting screw (do not remove it).
3. **Attach the Bracket** – Place the bracket over the screw and tighten it. Do not overtighten the connector mounting screw.
4. **Secure the Cable** – Tighten the tie wrap around the connector and bracket, and cut off the extra length.

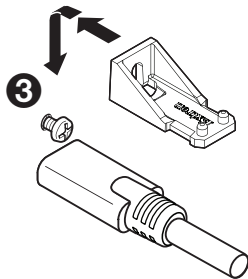
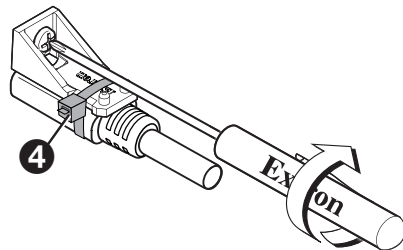
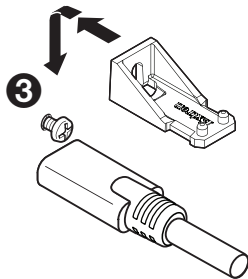
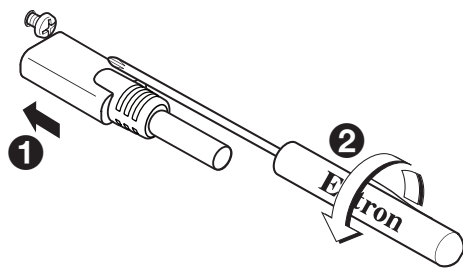

LockIt Plus • Installation Guide (Cont.)

Applications

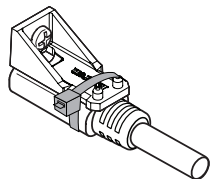

USB-C

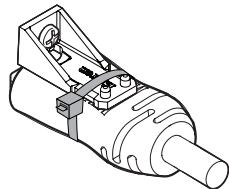

HDMI

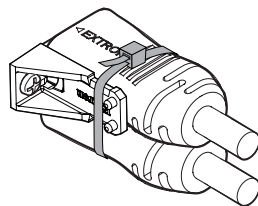

HDMI
Stacked

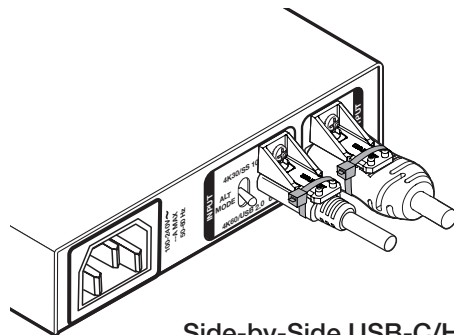

Side-by-Side USB-C/HDMI

For information on safety guidelines, regulatory compliances, EMI/EMF compatibility, accessibility, and related topics, see the [Extron Safety and Regulatory Compliance Guide](#) on the Extron website.

© 2025 Extron — All rights reserved. www.extron.com

All trademarks mentioned are the property of their respective owners.

Worldwide Headquarters: Extron USA West, 1025 E. Ball Road, Anaheim, CA 92805, 800.633.9876

68-3859-50 Rev. A

05 25