

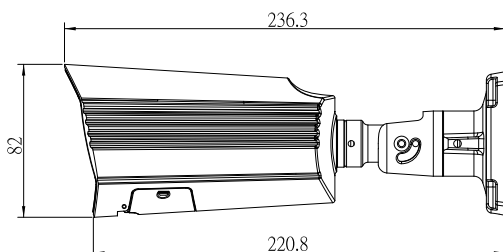

TIME-LAPSE IP CAMERA HS-T090KD-M

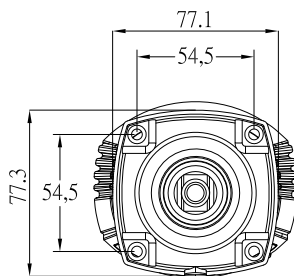

- H.265 / H.264
- 5MP (2592 × 1944)
- 30 m IR night view distance
- 3 DNR, Digital WDR, Digital Defog
- Built-in micro SD card slot, up to 128GB
- Automatically compile the Time-Lapse movie clips
- Support long-term construction time lapse
- IP68 ingress protection
- Flexible video recording by SD card or NVR
- Installation: Wall mounting / pole mounting / mobile mounting
- Optional Power Supply: DC12V / solar panels / rechargeable Battery & control units

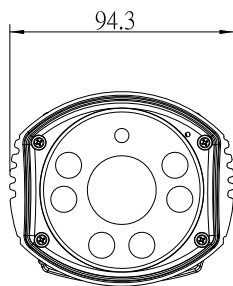

RoHS CE FC





HS-T090KD-M

Camera		
Image Sensor	1 / 2.8 " CMOS	
Image Size	2592× 1944	
Electronic Shutter	1 / 10 s ~ 1 / 10,000 s	
Min. Illumination	0.01 lux @F1.3, AGC ON; 0 lux with IR	
Lens	EVF 2.8 ~ 12 mm @F1.3	
Horizontal view Angle	97° ~ 30°	
IR Distance	30 m	
WDR	YES	
BLC	YES	
HLC	YES	
Digital Defog	YES	
Digital DNR	3D DNR	
Image		
Video Compression	H.265 / H.264	
H.265 Compression Standard	Main Profile	
Resolution	5MP (2592 × 1944)	
Main Stream (S1)	5MP @30fps	
Bit Rate	512Kbps ~ 8192 Kbps	
Bit Rate Type	VBR / CBR	
Image Settings	White Balance, Exposure Time, Hue, Mirror, Flip, Saturation, Brightness, Contrast, Wide Dynamic, Sharpen,NR,etc. adjustable through client software or web browser	
ROI	YES	
Time-Lapse		
Capture Duration	1~86400 second(s)	
FPS	1~60 frame(s)	
Time Stamp	Text	on / off
	Datetime	on / off
	OSD Display	Left Top / Center Top / Right Top Left Bottom / Center Bottom / Right Bottom
Flicker Free	50Hz / 60Hz	
Video Format	AVI	
Image Format	JPEG	
Interfaces		
Network	RJ45	
Storage		
SD card	Built-in micro SD card slot; up to 128GB	
Network remote storage	YES	

Functions	
Network Protocol	TCP, IP, UDP, DHCP, NTP, RTSP, DDNS, SMTP, FTP
Interface Protocol	ONVIF
Smart Alarm	Motion detection, Audio Alarm
General function	Video Setting, Camera Setting, Storage Setting Event Setting, Network Setting, System Setting
PoE	Yes
Others	
Power Supply	DC 12V / PoE 48V
Power Consumption	< 5W (IR off) / < 8W (IR on)
Operating Environment	- 10 ° C ~ 50 ° C (14° F ~ 122° F) Humidity: less than 85 % (non-condensing)
Dimensions	236.3 x 94.3 x 82mm
Weight	Approx. 850g
Ingress Protection	IP68
Accessories(Optional)	
	
Pole Bracket HS-B670	Junction Box HS-B662