

SFP Port Blocker: Key & Lock

Model No. WST-SSF001 / WST-SSF002
WST-SSF003 / WST-SSF004



Introduction

Wavesplitter SFP Port Blocker enhances system security by protecting against unwanted network access to your SFP ports. It also works as port savers or as indicators for inactive ports. To use the Port Blocker, simply insert a Lock into a duplex SFP female port. The special structure of the Key allows it to easily remove a Lock from a port without creating any damage to the port. The Wavesplitter SFP Port Blocker is a simple and easy-to-use product but plays an important role in network security .

Key Features

- Easy to use; no need for additional software installation
- Prevents unauthorized personnel from connecting to a network or system through SFP ports
- Keys are only compatible with blockers of the same color
- Patented product

Package Contents

SFP Port Blocker Key and Locks. Please see below for more details.

Product Family

Model No.	WST-SSF001	WST-SSF002	WST-SSF003	WST-SSF004
Content	Key (Red) x 1	Locks (Red) x 10	Key (Green) x 1	Locks (Green) x 10
Barcode	4710582480553	4710582480560	4710582480577	4710582480584

Specification Sheet

Specifications

Port Blocker Key	
Main Material	PC
Size W x D x H	17.50 x 4.80 x 60.35mm
Color	Red / Green
Port Blocker Lock	
Interface	SFP
Main Material	PC
Size W x D x H	13.80 x 18.50 x 10.08mm
Color	Red / Green
Environment	
Operating Temperature	0°C~55°C
Storage Temperature	-10°C~60°C
Package	
Package Style	Polybag
Warranty	1 Year
Certification	
Safety & Emission	RoHS / REACH / UL
Country of Origin	Taiwan

Instructions

HOW TO USE

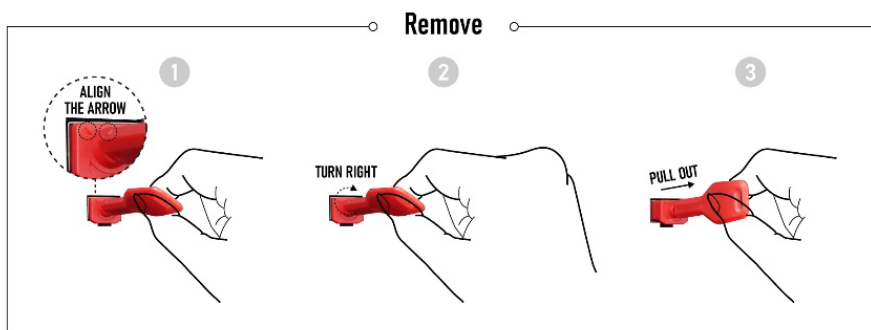
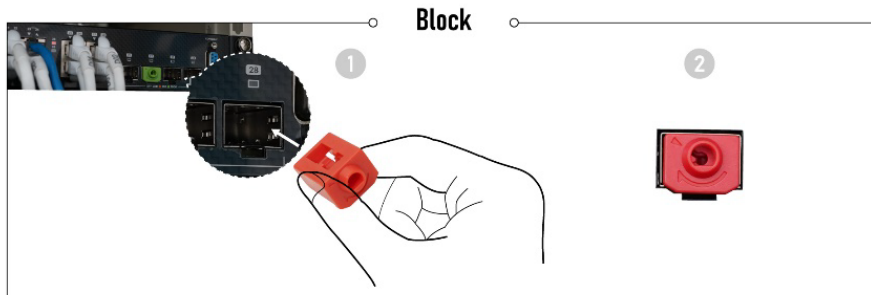

HOW TO USE

